

RIGHT HOME | AREA
333 IZMIR



RIGHTHOME.COM.TR

righthome
real estate consultancy

Project Overview



Project area
34.433 M²

This project is located in Boyalık in Izmir city.

There are 4 different types of housing units that are available as 1+1, 2+1, 3+1 and 4+1.

The land area of the project is 11.670 m², and the construction area is 22.763 m².

The project has 36 units in total.

The project is designed for those who wish to revel in a distinguished residency life with a modern luxury approach.

Project Site

This project is located in Boyalık in Izmir city.
The project is 9 kilo meters from the PORT ALAÇA.
The project is 9 kilo meters from the PAŞALİMANI BAY.
The project is 5 kilo meters from the ALAÇATI MARKET.
The project is 4 kilo meters from the SHERATON
HOTEL.

BOYALIK
BEACH

300

m

ALTIN YUNUS
MARINA

1

km

AQUA TOY
CITY

2

km

AYA YORGI
BAY

2

km

ÇEŞME
MARINA

3.5

km

ILICA
BEACH

4

km



Project's Features



Garden



Elevator



Security



Play-
grounds



Children's
Playground



Swimming
Pool



Sauna



Gym



Parking



Turkish
Bath



Project's
Photos



Project's
Photos

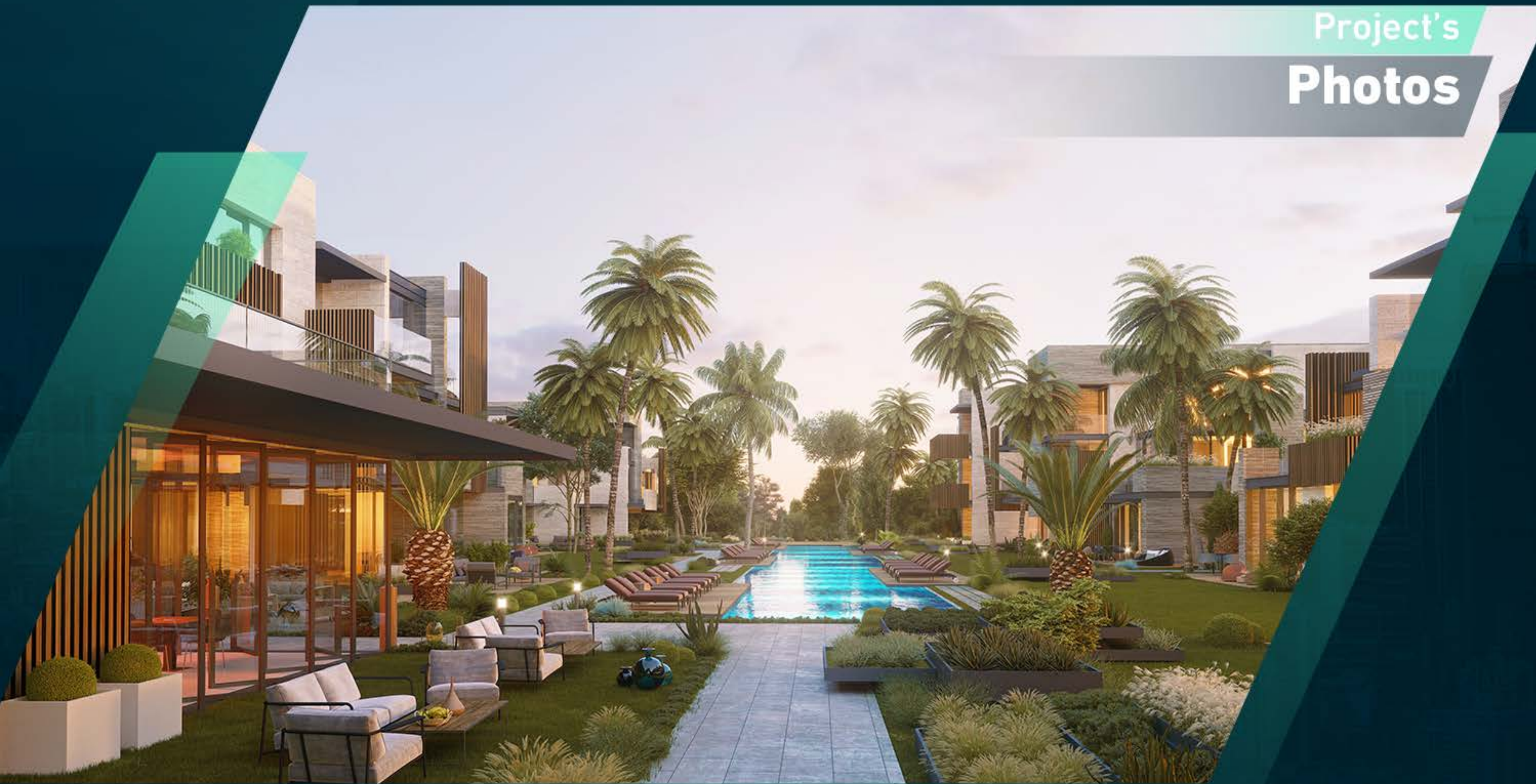

Project's
Photos



Project's
Photos



Project's
Photos



Project's
Photos



Project's
Photos



About Us

Right Home is a leading company specializing in real estate consultancy and brokerage.

We help buyers **to buy** and sellers **to sell**.

We provide luxury apartments, smart homes, elegantly designed offices, modern constructions and all consultancy services.

Our head office located in **Istanbul**, Turkey.

righthome
real estate consultancy

 righthome_tr
 righthome_tr
 righthome
 righthometr
 +90 212 573 51 93
 www.righthome.com.tr
 info@righthome.com.tr